

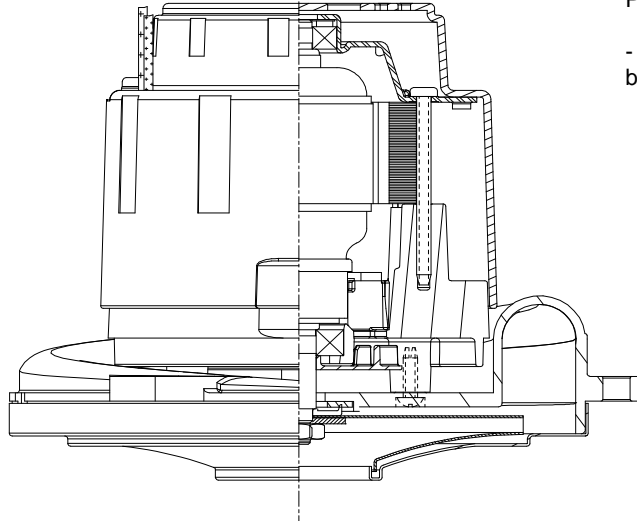

Model: **122588-00**

**DESCRIPTION**

- 12 volts DC
- Single stage tapered fan
- 6.6" / 162 mm diameter
- Improved sound quality
- "True" tangential discharge bracket
- High-Efficiency "Galaxy" lamination
- Double ball bearings; 10mm output



**SPECIAL FEATURES**

- 3000+ hours life
- High efficient cooling system
- Lamb "Green Power Label"
- UL and cUL recognized, category PRGY2 (E47185).
- Includes Steel Rotating fans for backpressure applications

**DESIGN APPLICATION**

- Equipment operating in environments requiring separation of working air from motor ventilating air
- Designed to handle clean, dry, filtered air only

**TYPICAL MOTOR PERFORMANCE.\***

(At 12 VDC, test data is corrected to standard conditions of 29.92 Hg, 68° F.)

ASTM DATA

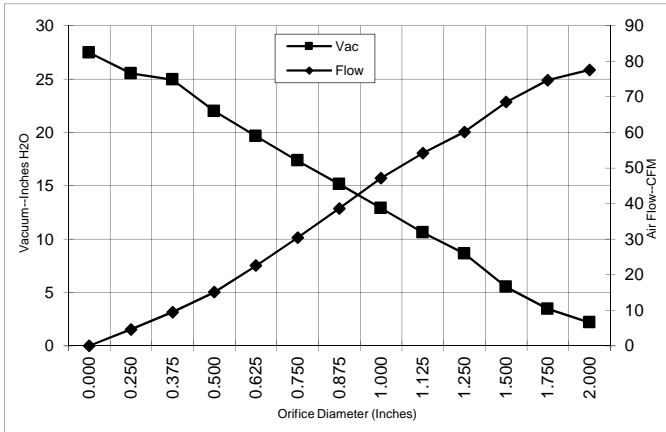

Orifice (Inches)	Amps	Watts (In)	RPM	Vac (In.H2O)	Flow (CFM)	Air Watts
2.000	21.9	264	11786	2.2	77.6	20
1.750	22.0	265	11740	3.4	74.7	30
1.500	22.0	266	11783	5.5	68.5	44
1.250	22.0	266	11884	8.6	60.1	61
1.125	21.9	264	11944	10.6	54.2	68
1.000	21.7	262	12100	12.9	47.2	71
0.875	21.3	258	12375	15.1	38.6	69
0.750	20.7	251	12734	17.4	30.4	62
0.625	20.0	243	13222	19.6	22.5	52
0.500	18.6	230	13819	22.0	15.1	39
0.375	18.2	222	14529	24.9	9.5	28
0.250	17.6	215	15119	25.5	4.6	14
0.000	17.1	209	15530	27.5	0.0	0

METRIC DATA

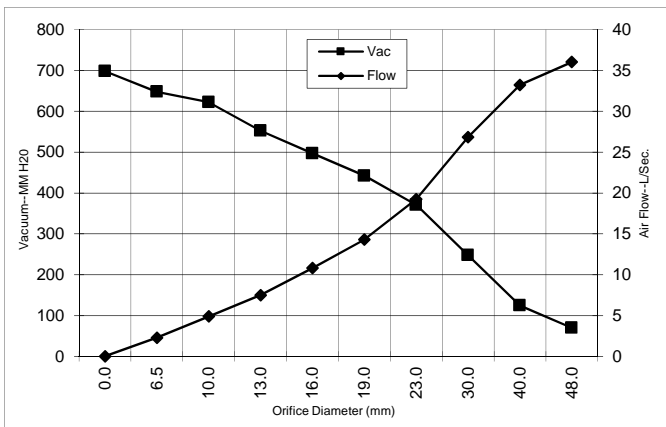

Orifice (mm)	Amps	Watts (In)	RPM	Vac (mm H2O)	Flow (L/Sec)	Air Watts
48.0	21.9	265	11766	69	36.0	24
40.0	22.0	266	11770	124	33.2	40
30.0	21.9	265	11917	247	26.8	65
23.0	21.4	259	12306	370	19.2	69
19.0	20.7	251	12744	442	14.3	62
16.0	20.0	243	13203	497	10.8	52
13.0	18.7	231	13759	552	7.5	40
10.0	18.3	223	14423	622	4.9	29
6.5	17.6	215	15089	648	2.3	14
0.0	17.1	209	15530	698	0.0	0

Note: Metric Performance data is calculated from the ASTM data above.

\* Data represents performance of a typical motor sampled from a large production quantity. Individual motor data may vary due to normal manufacturing variations.

Test Specs:	12	Minimum Sealed Vacuum:	23.0	ORIFICE:	0.875	Minimum Vacuum:	13.0	Maximum Watts:	290
-------------	----	------------------------	------	----------	-------	-----------------	------	----------------	-----

**DIMENSIONS**

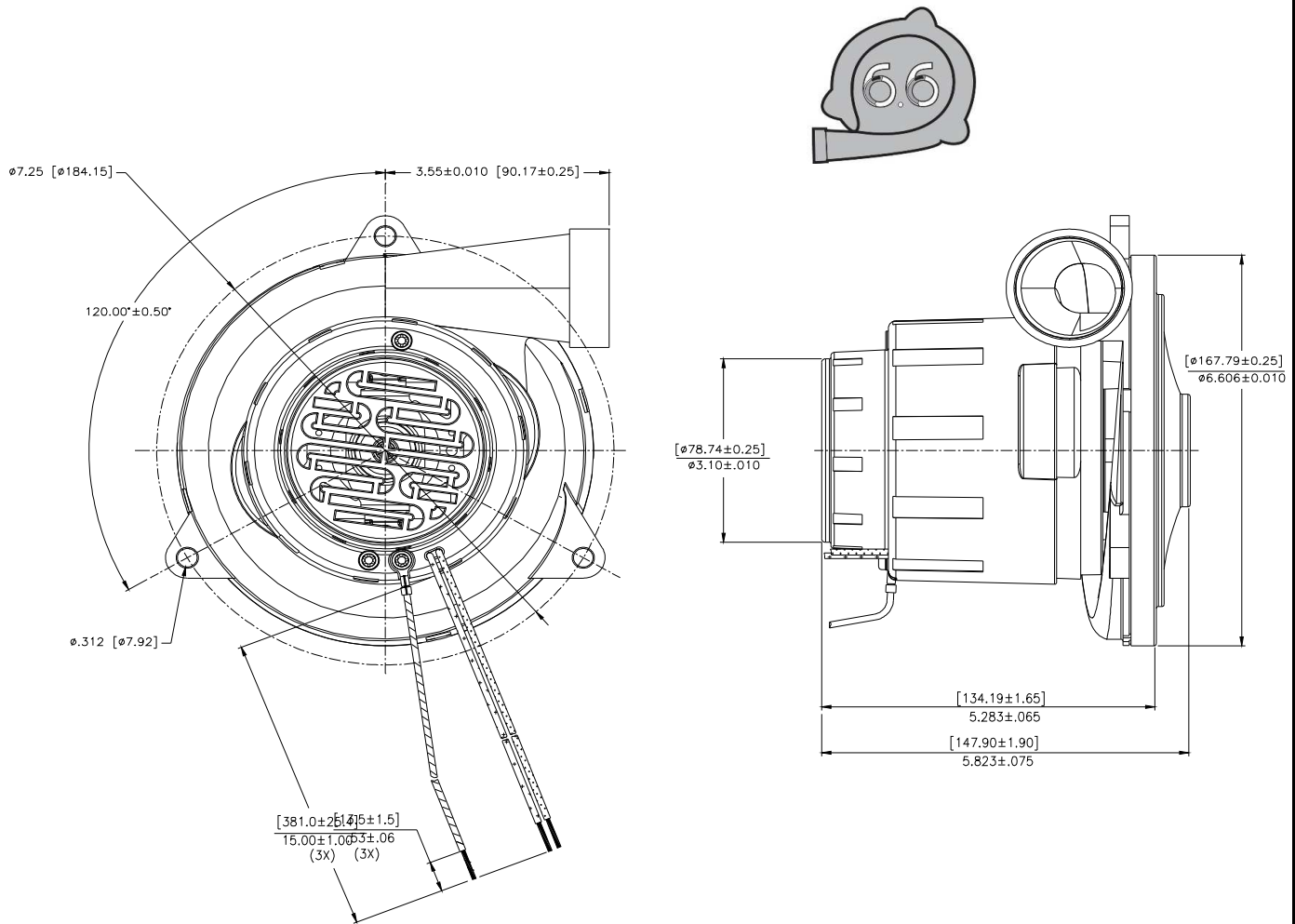

**IMPORTANT NOTE:** Pictorial and dimensional data are subject to change without notice. Contact factory for current revision levels.

**WARNING** - When using AMETEK Floorcare & Specialty Motors (F&SM) bypass motors in machines that come in contact with foam, liquid (including water), or other foreign substances, the machine must be designed and constructed to prevent those substances from reaching the fan system, motor housing, and electrical components. F&SM vacuum motors other than hazardous duty models should not be applied in machines that come in contact with dry chemicals or other volatile materials. Failure to observe these precautions could cause flashing (depending on volatility) or electrical shock which could result in property damage and severe bodily injury, including death in extreme cases. All applications incorporating F&SM motors should be submitted to appropriate organizations or agencies for testing specifically related to the safety of your equipment.

**AMETEK/Floorcare & Specialty Motors**  
**www.ametekfsm.com**

Revised May 2017